

Driver LC 8W 180/200mA fixC SR SNC2 China Domestic  
essence标准版系列

**产品描述**

- \_ 具有应力消除的独立 LED 驱动
- \_ 适用于受限安装条件的额外扁平外壳 ( 小天花板切口和低天花板空隙 )
- \_ 适用M类和MM类应用环境，符合 EN 60598, VDE 0710, VDE 0711
- \_ 耐热保护符合EN61347-2-13 C5e标准
- \_ 输出电流180或 200 mA
- \_ 最大输出功率8W
- \_ 高达30,000小时的额定寿命
- \_ 3年质保

**外壳特性**

- \_ 外壳: PC塑料, 白色
- \_ 安全等级IP20
- \_ 插入式端子
- \_ 2个独立的应力消除部件，用于输入和输出电缆，具有高度坚固的夹具

**功能**

- \_ 过载保护
- \_ 短路保护
- \_ 空载保护
- \_ 电源开关时无输出电流过冲
- \_ 爆炸保护电压 1kV
- \_ 浪涌保护电压 0.5 千伏 ( L 和 N 之间 )
- \_ 浪涌保护电压 1 千伏 ( L/N 和接地之间 )

**典型应用**

- \_ 用于零售业和医院的聚光灯和筒灯
- \_ 用于办公室和教室应用中的面板灯和区域灯

**Website**

<http://www.tridonic.cn/23000286>



Spotlights



Downlights



Linear



Area



Floor | Wall



Free-standing



Street



Decorative



High bay

## Driver LC 8W 180/200mA fixC SR SNC2 China Domestic

essence标准版系列

您可以在下载区域找到这一产品的完整数据资料。

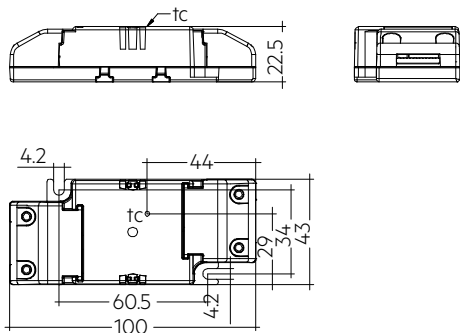

## Ordering data

Type	Article number	Packaging, carton	Packaging, low volume	Packaging, high volume	Weight per pc.
LC 8/200/40 fixC SR SNC2	23000286	19 pc(s).	703 pc(s).	5,624 pc(s).	0.052 kg

## Technical data

Rated supply voltage	220 – 240 V
交流电压范围	198 – 264 V
$\lambda$ at full load	0.5C
$\lambda$ at min. load	0.5C
Mains frequency	50 / 60 Hz
Overvoltage protection	320 V AC, 1 h
Leakage current (at 230 V, 50 Hz, full load)	< 450 $\mu$ A
THD (at 230 V, 50 Hz, full load)	$\leq$ 160 %
Output current tolerance <sup>①</sup>	$\pm$ 7.5 %
Typical output LF current ripple at full load	$\pm$ 5 %
Starting time (at 230 V, 50 Hz, full load)	$\leq$ 0.5 s
Turn off time (at 230 V, 50 Hz, full load)	$\leq$ 0.5 s
Hold on time at power failure	0 s
环境温度 $t_a$	-25 ... +50 °C
Ambient temperature $t_a$ (at life-time 30,000 h)	40 °C
Storage temperature $t_s$	-40 ... +80 °C
寿命	up to 30,000 h
尺寸 长 x 宽 x 高	100 x 43 x 22.5 mm

## Approval marks

IP20 SELV RoHS

## Standards

EN55015, EN 60598-1, EN 61000-3-2, EN 61000-3-3, EN 61347-1, EN 61347-2-13, EN 61547

## Specific technical data

Type	输出电流 <sup>①</sup>	Input current (at 230 V, 50 Hz, full load)	Max. input power	Typ. power consumption (at 230 V, 50 Hz, full load)	Output power range	Efficiency at full load <sup>②</sup>	Efficiency at min. load <sup>②</sup>	Min. forward voltage <sup>②</sup>	Max. forward voltage <sup>②</sup>	Max. output voltage (U-OUT)	Max. peak output current	Max. casing temperature $t_c$
LC 8/200/40 fixC SR SNC2	200 mA	88 mA	10 W	9.5 W	4.6 – 8.0 W	82 %	80 %	23 V	40 V	100 V	225 mA	75 °C

- ① Output current is mean value.
- ② Test result at 230 V, 50 Hz.